

TONY DREW PHOTOGRAPHY

2025

Property Photography & Floorplan Services

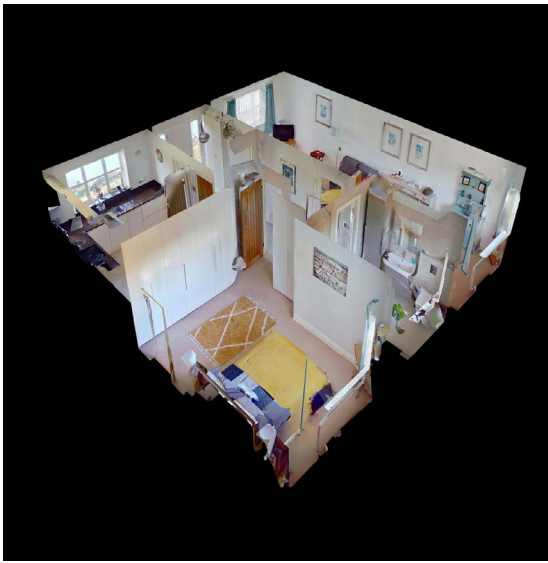

PROPERTY PHOTOGRAPHY & FLOOR-PLAN SERVICES

2D Floor-plans and quality images are an essential part of property marketing, allowing prospective purchasers to view and assess the dwelling before viewing, Combine the two services to make effective savings

1000sqft 10 images + 2D plans £149.00
 2000sqft 20 images + 2D plans £249.00
 3000sqft 30 images + 2D plans £349.00

For 3D floor-plans and commercial buildings please call for an estimate based on your requirements.

Approx Gross Internal Area
 56 sq m / 602 sq ft

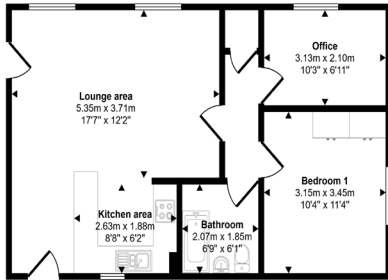

Floorplan

Whilst every attempt has been made to ensure the accuracy of the floor plan contained here, measurements of doors, windows, rooms and any other items are approximate and no responsibility is taken for any error, omission, or mis-statement. The measurements should not be relied upon for valuation, transaction and/or funding purposes. This plan is for illustrative purposes only and should be used as such by any prospective purchaser or tenant.

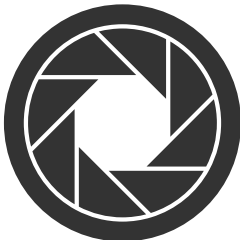

TONY DREW PHOTOGRAPHY
07968064116

Tony Drew Photography

07968064116

www.tonydrewphotography.co.uk

info@tonydrewphotography.co.uk

- ### WHAT DO I GET ?
- * Images captured on hires DSLR
 - * Plans delivered in JPEG or PDF format.
 - * Fast on the day turnaround (2D) Plans & images where possible.
 - * Free travel to the location within 10 miles.